

Pickit

A plug & play
3D camera
for your robot



ROBOT VISION MADE EASY

5 good reasons to automate with Pick-it



Save installation and setup time

Save setup time with our intuitive and easy to use 3D camera and software. With Pick-it, you can build any camera supported automation application without requiring experience. **Don't waste time** on long robot programs, Pick-it will tell your robot where to go.

Automate with full flexibility

Build a new application in a day or define a new product to pick in just a few minutes. The Pick-it software is designed to handle **fast adaptations** and change-over times. It nicely guides you through the picking steps with a best-in-class user interface.

Cut costs at a fixed price

Save costs using an **off-the-shelf product** that has proven itself with more than 150 applications in over 40 countries instead of going for a custom engineered approach with unpredictable results.

Get rid of bulky and space-taking fixtures

Since Pick-it can find parts in any sort of location and layout, there is **no need** for a bulky feeding line with custom, inflexible and expensive tools such as conveyors or belts, fixtures, feeders or shaker tables.

Worry less with 24/7 reliability

Rely on Pick-it to deliver **quality of work** day and night, seven days a week without getting tired. The Pick-it software even enables you to keep an eye on its eyes from wherever you are.



"If I wanted to, fresh from a sealed box, I could get the system unpacked, connected, powered up, and picking simple parts such as boxes or circles in just 2 hours (if we ignore that I read slow). I think it is very well designed for being a new product and very robust."

— Austin Shupe, Onexia, USA

Endless automation possibilities

Parts of different shapes, materials and sizes come into processes every day. They need to be ordered, placed, picked and mostly fed into a machine or a process.

Traditionally this task was very hard to automate. **Adding our 3D camera and software to your robot makes this automation step made easy for you.**

“Including unboxing and mounting the system, we can set up Pick-it to run a pick and place application with the UR robot in 3-4 hours.”

— Allied Automation, USA

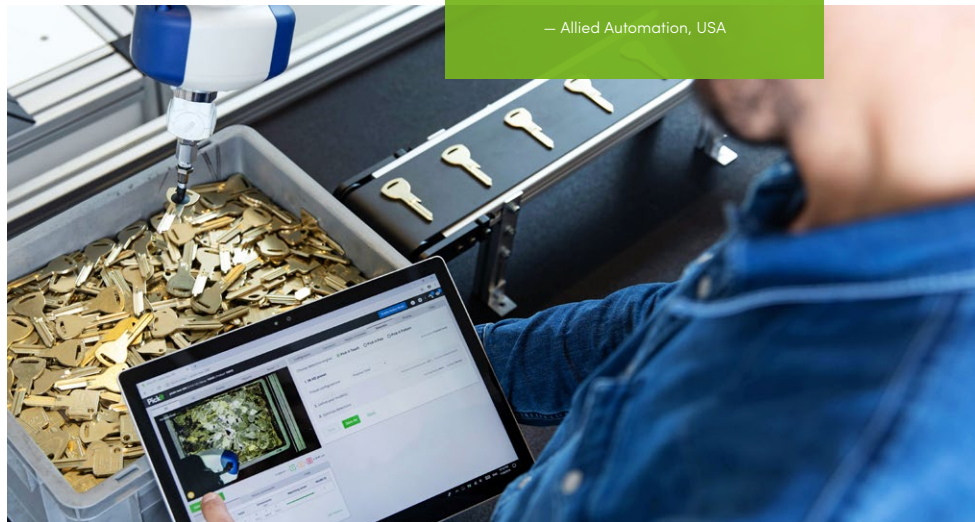

Pick-it can find parts

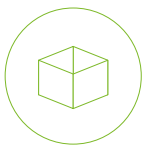

in bins



in boxes

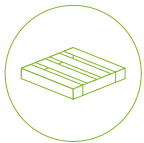

on pallets



on tables

and many more ...

Pick-it will show your robot where to pick parts and place them onto:

- a CNC Machine
- an assembly line
- a conveyor belt
- a welding station
- a working bench
- a tray
- a box
- a package
- a co-workers hand
- and many more

TRAINING

If you want to discover all possibilities of our system, learn how to use the latest features or just need that tiny bit of extra information to convince your team or management that Pick-it is the product you need, don't hesitate to request a training session. We offer **free training days** at our Belgium office targeted to anyone from Pick-it novices to seasoned experts. Aside from those we provide **online training materials and webinars** on <http://support.pickit3d.com>.

Challenge us with your application.

We're happy to help: pickit3d.com/contact

A plug & play solution

The Pick-it package contains a **3D camera** and the **3D Picking software** ready-to-run on a dedicated industrial processor.

Connect your pc or laptop to the Pick-it processor to configure your application through Pick-it's web interface.

Connect your robot to the Pick-it processor and program your robot with ready-to-use Pick-it commands to start picking.



“If I had to teach all waypoints for this application myself, this would have taken me 2 days. Now Pick-it does this for me. Just amazing.”

Yves Machiels, KUKA programmer, Belgium

No programming needed

To configure an application with Pick-it you don't need to write a single line of code. We guide you through your setup with our interactive web interface.

This is how it's done

- Show an example part to the plug & play 3D camera
- Save this into the Teach detection engine
- Tell Pick-it where to look with our click and drag tool
- Pick-it will tell your robot where the best pickable part is

Our artificial intelligence makes your robot smart

Our product:

- learns what your parts look like,
- knows where your robot is and how it moves,
- knows where your bin is,
- knows what your tool looks like,
- predicts & prevents collisions with obstacles and other parts,
- decides the best part to pick next,
- and much more ...

WE VALUE TIME AS MUCH AS YOU DO

A typical detection cycle takes **less than one second** and can find multiple parts in one cycle.

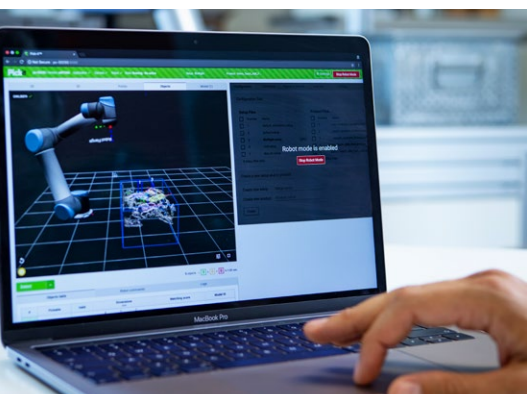

UR+ CERTIFIED

Setting up and running an application with Pick-it on your Universal Robots robot is nearly effortless with the free Pick-it URcap. The test and validation professionals at Universal Robots tested our 3D camera, software and URcap and labeled Pick-it as a UR+ certified solution.

support.pickit3d.com/urcap



An elegant solution for any pick and place application

NEW!



Pick-it M-HD

Best fit for picking of **small and medium sized objects** with **high accuracy** from bins, boxes and tables.

- High resolution 3D camera
- Highly accurate
- Best in class



Pick-it M

Best fit for picking of **medium sized objects** from bins, boxes and tables.

- Highly versatile 3D camera
- No parameters, real plug and play
- Fastest ROI in the market



Pick-it L

Best fit for picking of **large sized objects** from pallets and bins.

- High versatile 3D camera
- No parameters, real plug and play
- Fastest ROI in the market

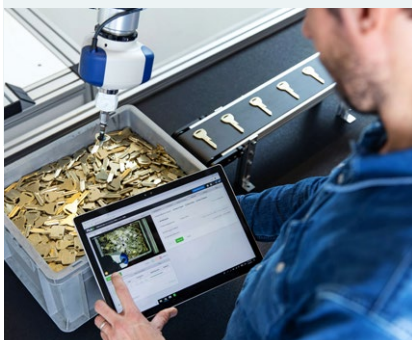

Pick-it M-HD facts

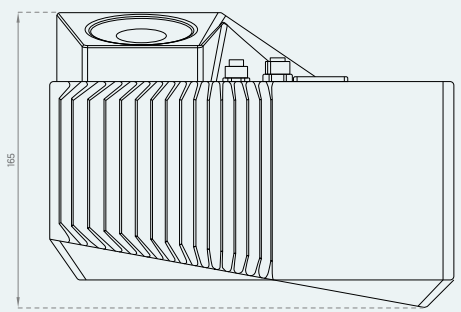
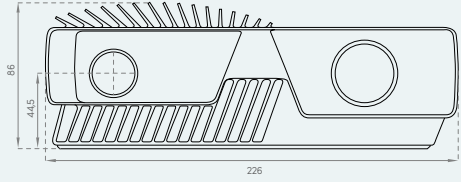

Minimum object size:
10 x 10 x 5 mm

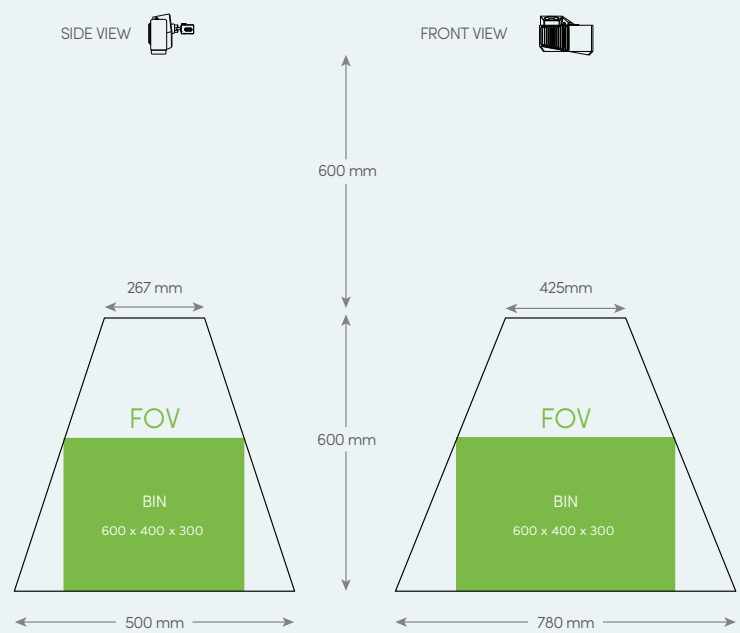
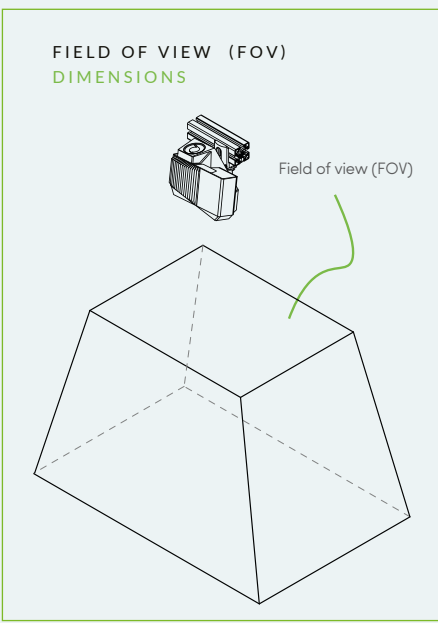
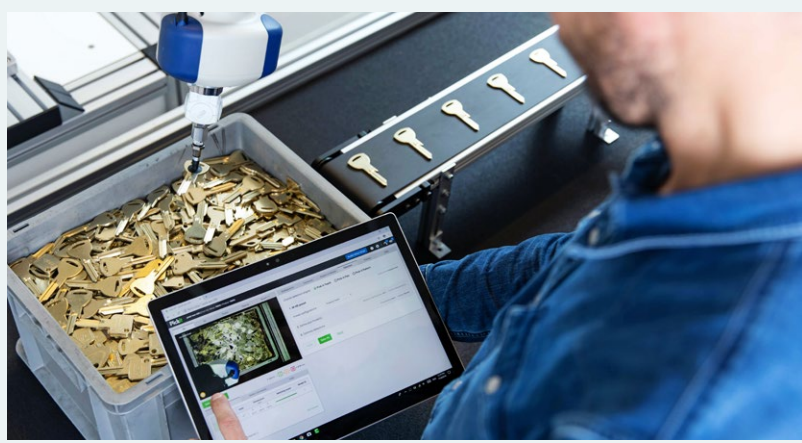
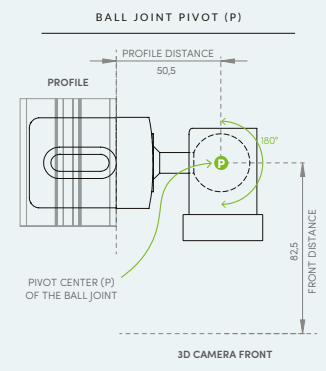
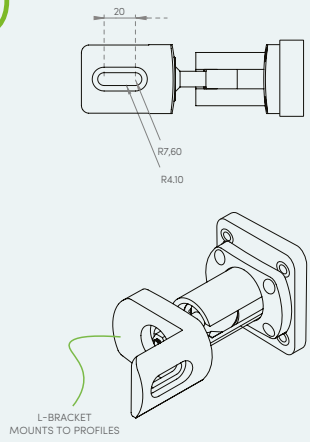



CAMERA TECHNICAL SPECIFICATIONS

3D measurement method	Structured light
Image processing speed	10 Hz (100ms snapshots)
3D Camera accuracy	0,1mm
3D Camera repeatability	< 1mm
3D camera weight	2 kg
3D camera connection to PC	M12-8 (USB) - USB3
PC connection to robot	TCP/IP over Ethernet
Power supply	M12-5 24VDC
Temperature	10°C to 40°C
IP rating	IP65
Vibrations	5G Sinus, 25G Shock
Conforms to	CE, CB, EN6950, FCC class A

CAMERA CABLE TECHNICAL SPECIFICATIONS

10m

Industrial M12 camera connector

High-Flex / Continuous-Flex

- Type-U (R= 67,5mm - 5.000.000 times)
- Type-S (R= 60mm - 1.000.000 times)
- 90° Tick-Tock bending (R= 60mm - 1.000.000 times)

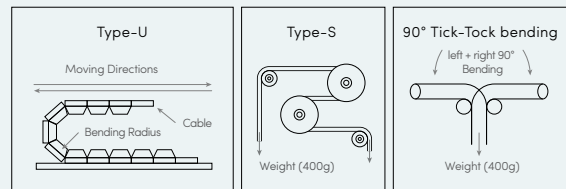

PROCESSOR

Power consumption

- While turned off: 25W
- Booting: 115W
- Idle: 70W
- Heavy processing: 160W

Technical specifications

- Processor: 6 cores (12 threads) at 3.7 Ghz
- 19 inch server: rack compatible (2U)
- Temperature: -20°C to 70°C
- Vibrations: Operating, 5 Grms, 5-500 Hz, 3 axes
- IP rating: IP54
- Power supply: 9-32V DC 160W
- Humidity: -95% @ 40°C (non-condensing)

WORKS WITH YOUR ROBOT

FANUC STÄUBLI KUKA YASKAWA ABB

UNIVERSAL ROBOTS

FRANKA EMIKA

AUBO ROBOTICS

Pick-it M facts

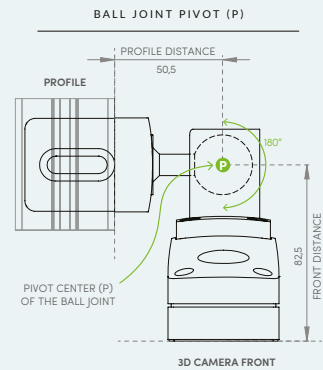
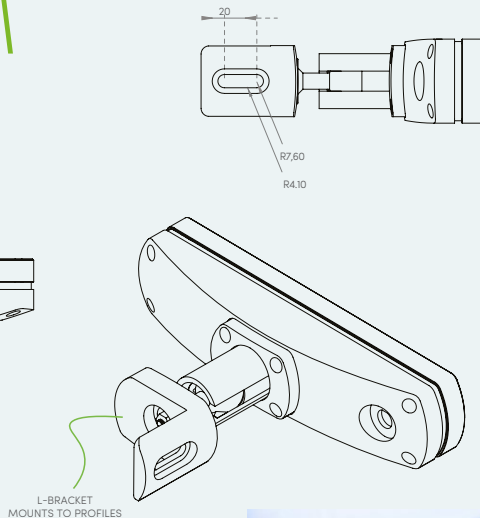
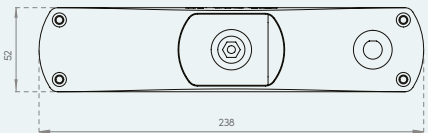
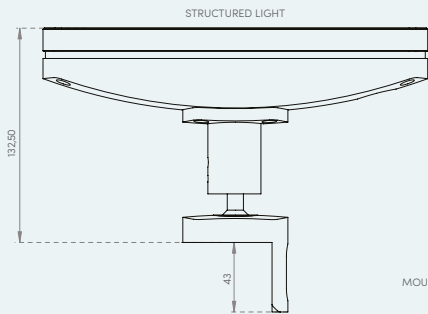

Minimum object size:
50 x 50 x 10 mm

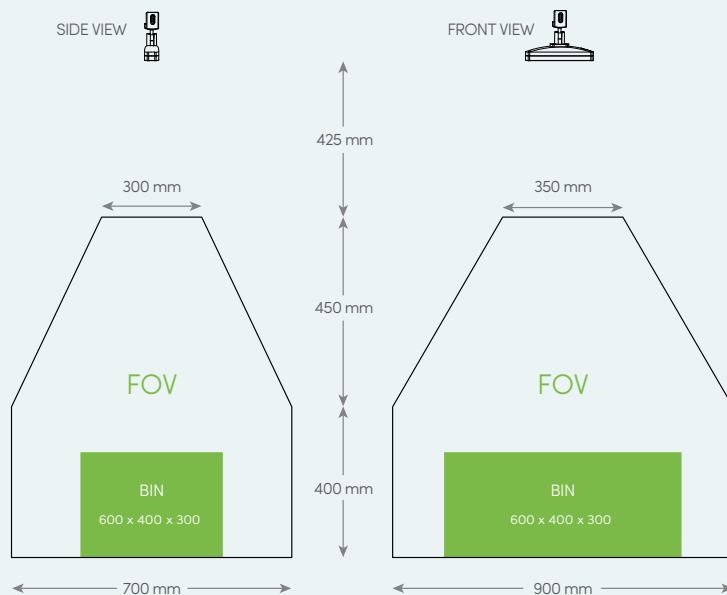
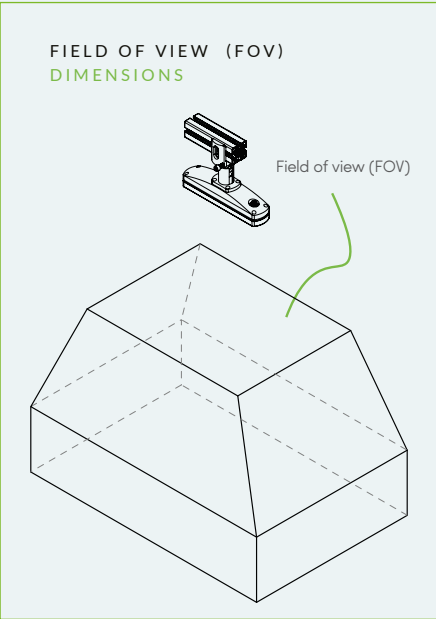



CAMERA TECHNICAL SPECIFICATIONS

3D measurement method	Structured light
Image processing speed	30 fps
3D Camera accuracy	< 3mm
3D Camera repeatability	< 1mm
3D camera weight	1030 g
3D camera connection to PC	M12 (USB) - USB3
PC connection to robot	TCP/IP over Ethernet
Power supply	USB3 5VDC
Temperature	5°C to 40°C
Humidity	-95% @ 40°C (non-condensing)
IP rating	IP55
Vibrations	Operating, 2 Grms, 5-500 Hz, 3 axes
Conforms to	CE, FCC



CAMERA CABLE TECHNICAL SPECIFICATIONS

10m

Industrial M12 camera connector

High-Flex / Continuous-Flex

- Type-U (R= 67,5mm - 5.000.000 times)
- Type-S (R= 60mm - 1.000.000 times)
- 90° Tick-Tock bending (R= 60mm - 1.000.000 times)

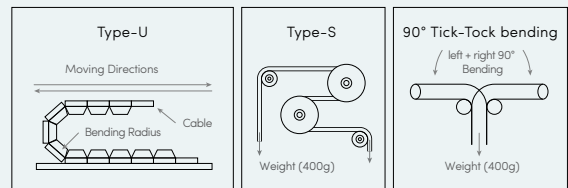

PROCESSOR

Power consumption

- While turned off: 25W
- Booting: 100W
- Idle: 60W
- Heavy processing: 130W

Technical specifications

- Processor: 6 cores (12 threads) at 3.7 Ghz
- 19 inch server: rack compatible (2U)
- Temperature: -20°C to 70°C
- Vibrations: Operating, 5 Grms, 5-500 Hz, 3 axes
- IP rating: IP54
- Power supply: 9-32V DC 160W
- Humidity: -95% @ 40°C (non-condensing)

WORKS WITH YOUR ROBOT



Pick-it L facts

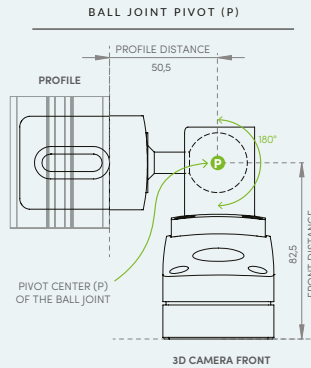
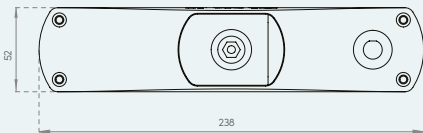
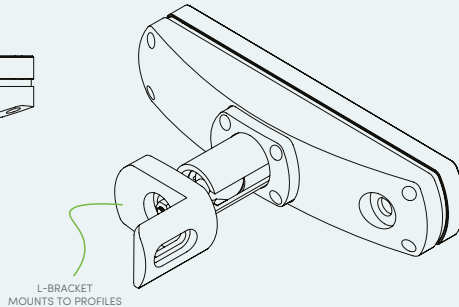
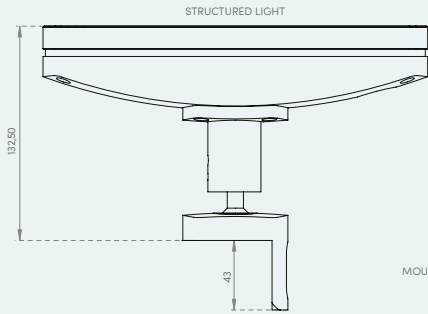
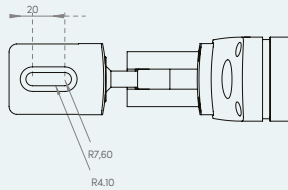

Minimum object size:
150 x 150 x 50 mm

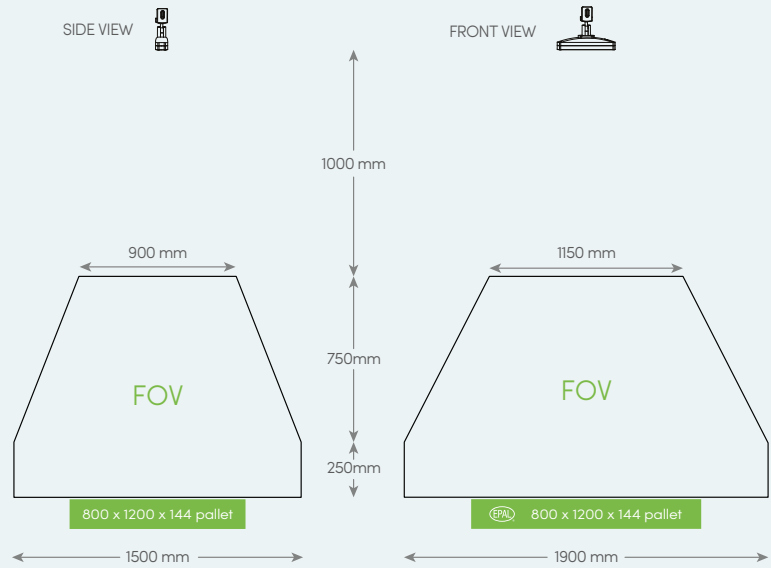
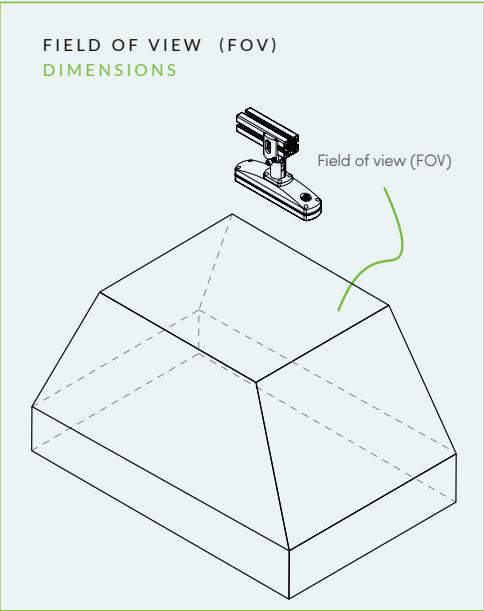

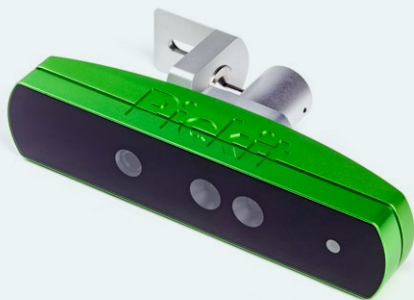

CAMERA TECHNICAL SPECIFICATIONS

Temperature	5°C to 40°C
Vibrations	Operating, 2 Grms, 5-500 Hz, 3 axes
IP rating	IP55
Power supply	USB3 5VDC
Humidity	-95% @ 40°C (non-condensing)
3D measurement method	Structured light
Image processing speed	30 fps
3D camera weight	1030 g
3D camera connection to PC	M12 (USB) - USB3
PC connection to robot	TCP/IP over Ethernet
Conforms to	CE, FCC



CAMERA CABLE TECHNICAL SPECIFICATIONS

10m

Industrial M12 camera connector

High-Flex / Continuous-Flex

- Type-U (R= 67,5mm - 5.000.000 times)
- Type-S (R= 60mm - 1.000.000 times)
- 90° Tick-Tock bending (R= 60mm - 1.000.000 times)

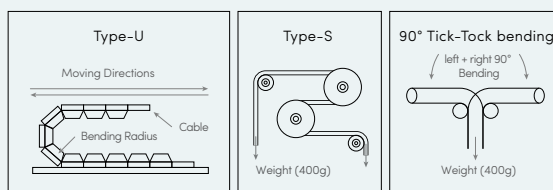

PROCESSOR

Power consumption

- While turned off: 25W
- Booting: 100W
- Idle: 60W
- Heavy processing: 130W

Technical specifications

- Processor: 6 cores (12 threads) at 3.7 Ghz
- 19 inch server: rack compatible (2U)
- Temperature: -20°C to 70°C
- Vibrations: Operating, 5 Grms, 5-500 Hz, 3 axes
- IP rating: IP54
- Power supply: 9-32V DC 160W
- Humidity: -95% @ 40°C (non-condensing)

WORKS WITH YOUR ROBOT





A global network for excellent local support

At Pick-it, we put a lot of effort into finding the best partners around the globe. These partners are professionally trained Pick-it experts that can help you set it up at your facility. Don't hesitate to get in touch with them.

www.pickit3d.com/certified-channel-partners

ONLINE KNOWLEDGE BASE

Pick-it's extensive online knowledge base contains more than 100 articles that provide interactive materials to guide first users through setting up their first application, connecting to a specific type of robot and helping experts to start using advanced features to get the most out of their system.

support.pickit3d.com

Contact us

Our mission is to help you save time, lower costs and ensure a reliable output with a product that ensures the fastest ROI on the market so you can start focussing on the things that matter most.

Are you interested in our product? Do you want to become a Pick-it partner?

sales@pickit3d.com

www.pickit3d.com

+32 16 624 882

 @pickit3d